

SHOBHA CAMELLIA

APPROVED LAYOUT OF HOUSE SITES IN SURVEY NO 22/4A OF PADUR VILLAGE,
THIRUPORUR TALUK, CHENGALPET DISTRICT.

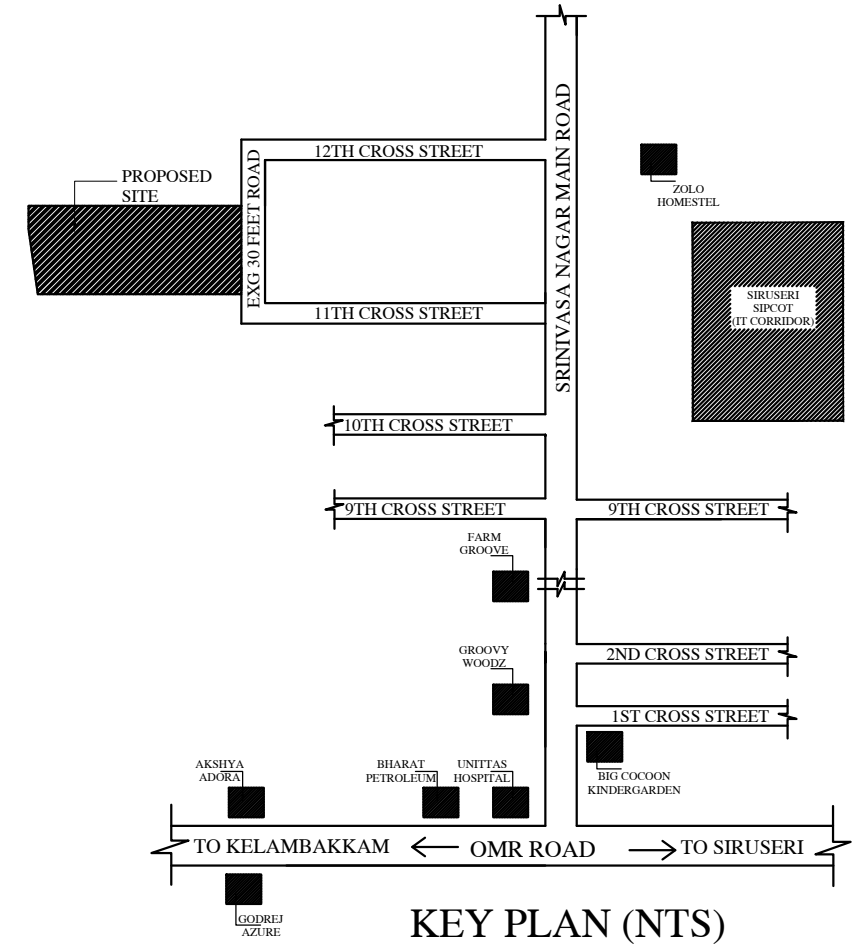
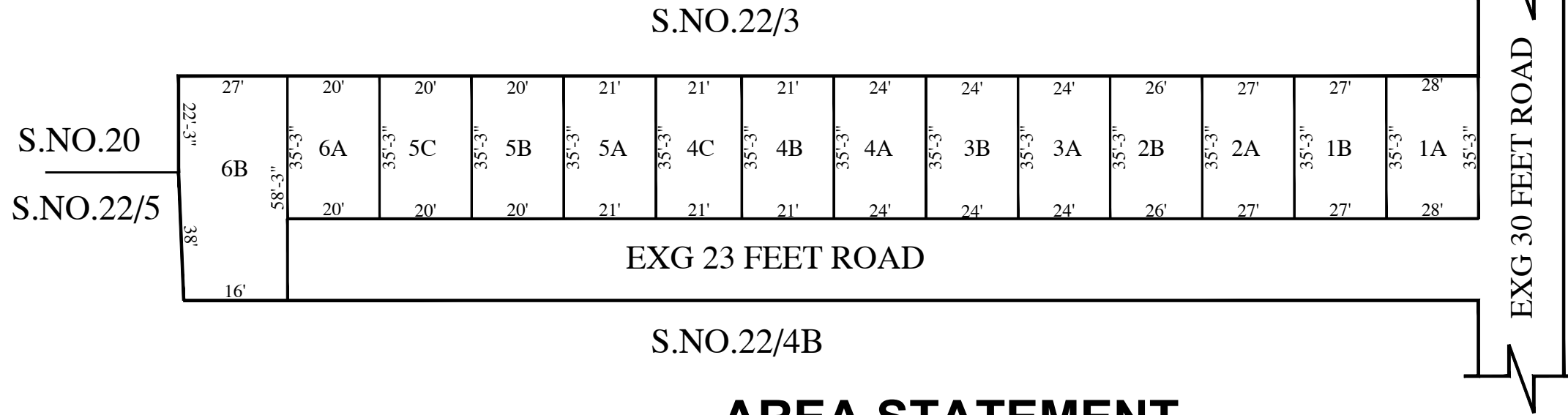
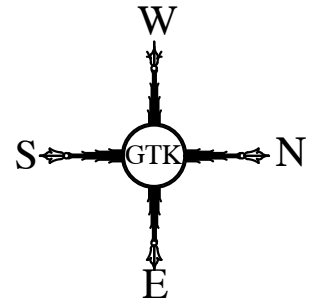

AREA STATEMENT

PLOT NOS	AREA IN Sq.ft	PLOT NOS	AREA IN Sq.ft
1A	987	4B	740
1B	952	4C	740
2A	952	5A	740
2B	916	5B	705
3A	846	5C	705
3B	846	6A	705
4A	846	6B	1407



PROJECT :	SHOBHA CAMELLIA
OFFICE ADDRESS:-	 GTK FOUNDATIONS No: 2/14, OLD STATE BANK COLONY WEST TAMBARAM CHENNAI - 45 PHONE - 81449 81449
DRAWING NO: GTK/SC/ML/01	PREPARED BY : K.VISHNUPRIYAN CHECKED BY : V.VINOTHINI APPROVED BY : G.T.KARTHIKEYAN